



## Applications

Thrust bearing swivels are used to prevent wire rope or chain from transferring their normal twisting motion to the item being lifted. Our swivels can be supplied with two types of end fittings.

Green Pin® swivels are not designed to rotate under load, but are intended as positioning devices only. For rotation under load, thrust bearing swivels should be used.

## Range

Van Beest offers two types of swivels:

- Green Pin® swivels, ranging from Working Load Limit 0.39 up to 20.5 tons, with eye-eye or jaw-eye terminals;
- Thrust bearing swivels, ranging from Working Load Limit 1 up to 40 tons, with eye-eye terminals.

Van Beest can also offer other types of swivels in grade 8 and grade 10.

Please see our Excel® catalogue for more information.



## Design

The Green Pin® swivels are dropforged whereas the thrust bearing swivels are machined from carbon steel. The range of thrust bearing swivels we supply are fitted with grease nipples to ensure long life and ease of operation. Greasing depends on the frequency and intensity of use. Each swivel carries the WLL marking, the manufacturer's symbol and the CE conformity code.

## Finish

Green Pin® eye-eye and jaw-eye swivels are hot dipped galvanized. The thrust bearing swivels are painted.

## Certification

Test certificates can be supplied upon request.

## Instructions for use

Swivels should be inspected before use to ensure that:

- all markings are legible;
- swivels are free from nicks, gouges and cracks;
- a swivel with the correct Working Load Limit has been selected with respect to the load to be carried;
- swivels may not be heat treated as this may affect their Working Load Limit;
- the bolt, nut or any other locking system cannot vibrate out of position.

The WLL should be applied in a straight pull and overloads are prohibited. Side loading is not allowed since the swivels are not designed for this purpose.

Never replace a swivel pin or nut with a bolt other than the one designed for the purpose, as it may not be suitable for the load imposed.

It is required that the products are regularly inspected and that the inspection should take place in accordance with the safety standards given in the country of use. This is required because the products in use may be affected by wear, misuse, overloading etc. with a consequence of deformation and alteration of the material structure. Inspection should take place at least every six months and even more frequently when the swivels are used in severe operating conditions.

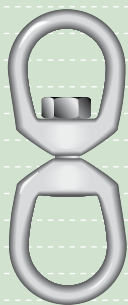

G-7713

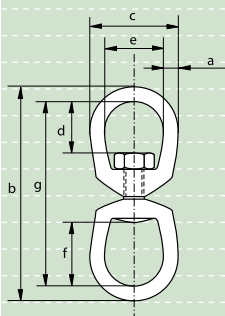

## Green Pin® swivels

### Eye - Eye

- **Material** : high tensile steel, quenched and tempered
- **Safety factor** : MBL equals 5 x WLL
- **Standard** : generally to US Federal Spec. RR-C-271, Type VII, Class 2
- **Finish** : hot dipped galvanized
- **Certification** : test certificates can be supplied upon request

working load limit	diameter	length outside	width outside	length inside	width inside	length inside	length	weight each
t	a mm	b mm	c mm	d mm	e mm	f mm	g mm	kg
0.39	6	87	32	18	19	27	75	0.1
0.57	8	106	41	21	25	32	90	0.18
1.02	10	129	51	24	32	38	109	0.32
1.6	13	164	64	33	38	51	138	0.6
2.4	16	199	76	40	44	60	167	1.13
3.3	19	221	89	44	51	67	183	1.82
4.5	22	257	102	52	57	78	213	2.83
5.7	25	295	114	59	64	89	245	4.06
8.2	32	337	143	68	80	94	273	7.43
20.5	38	501	178	102	102	150	425	20.8

1

2

3

4

5

6

7

8

9

10

11

12

13

14

15

16

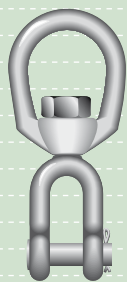

G-7723

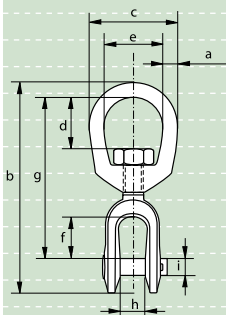

## Green Pin® swivels

### Jaw - Eye

- **Material** : high tensile steel, quenched and tempered
- **Safety factor** : MBL equals 5 x WLL
- **Standard** : generally to US Federal Spec. RR-C-271, Type VII, Class 3
- **Finish** : hot dipped galvanized
- **Certification** : test certificates can be supplied upon request

working load limit	diameter	length	width outside	length inside	width inside	length inside	length	width inside	diameter pin	weight each
t	a mm	b mm	c mm	d mm	e mm	f mm	g mm	h mm	i mm	kg
0.39	6	84	32	18	19	22	67	12	6	0.11
0.57	8	98	41	21	25	22	75	13	8	0.17
1.02	10	121	51	24	32	27	92	16	10	0.32
1.6	13	154	64	33	38	33	114	19	13	0.65
2.4	16	186	76	40	44	38	135	24	16	1.12
3.3	19	211	89	44	51	44	154	29	19	1.76
4.5	22	242	102	52	57	52	178	30	22	2.66
5.7	25	290	114	59	64	71	217	44	29	4.46
8.2	32	329	143	68	80	71	230	52	35	7.14
20.5	38	501	178	106	102	113	364	73	50	24.8



P-7740

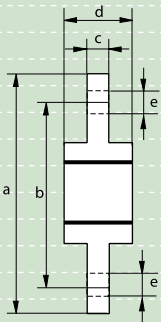

## Green Pin® Thrust bearing swivels

### Eye - Eye

- **Material** : carbon steel
- **Safety factor** : MBL equals 5 x WLL
- **Finish** : painted black
- **Certification** : test certificates can be supplied upon request

working load limit	length	length	thickness	diameter	diameter hole	weight each
t	a mm	b mm	c mm	d mm	e mm	kg
1	174	128	12.5	49	21	1.4
2	223	173	19	68	22	3.5
3	278	210	26	79	29	6.4
5	290	222	26	89	31	7.9
8	366	276	40	106	43	15.2
10	390	300	40	118	49	19.1
15	457	355	40	128	49	26.6
20	474	372	40	118	51	25
30	612	472	64	138	59	50
40	760	600	68	168	65	-

1

2

3

4

5

6

7

8

9

10

11

12

13

14

15

16